

Rotor

An optimum discharge unit for difficult to handle bulk materials stored in circular silos. Self-adjustment of the drag arm position and the driving torque control to the moving behaviour of the bulk material

Design characteristics

- robust construction
- circular construction form
- flexible or fixed drag arms

Applications

- bulk material reception
- bulk material intermediate storage
- bulk material division within the process
- in combination with SHW-relief systems to prevent stable bridge building

Customer advantages

- easy to maintain
- continuous discharge
- simultaneous feeding of up to six discharge screws

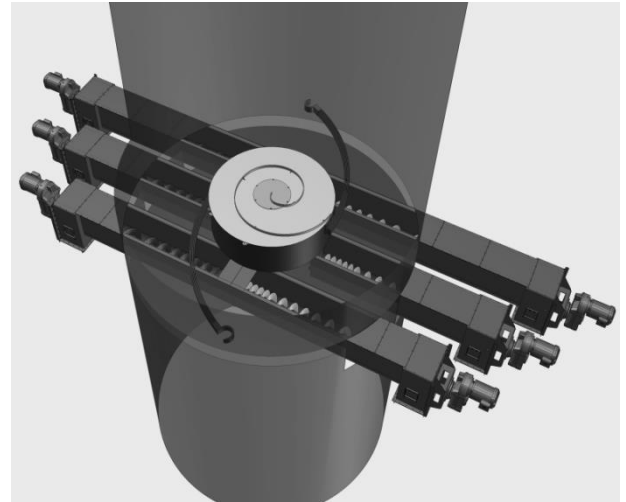

Technical data	
• discharge capacity	5 up to 300 m³/h per discharge screw
• driving power	5.5 up to 37 kW
• dimensions	2,500 up to 7,000 mm diameter
• weight	up to 10 t
• controls	function, optionally storage control
• wear protection	as an option, specially tailored to the application and the bulk material, for example different stainless steels, Hardox, wear protection welding, Infinite Shield (ceramic)
• execution	CE declaration of conformity ATEX: standard no ex-qualification alternatives: inside: zone 22 and outside: no zone (Ex II 3/-D) Inside and outside: zone 22 (Ex II 3/3 D)

Various possibilities for discharge screw positioning

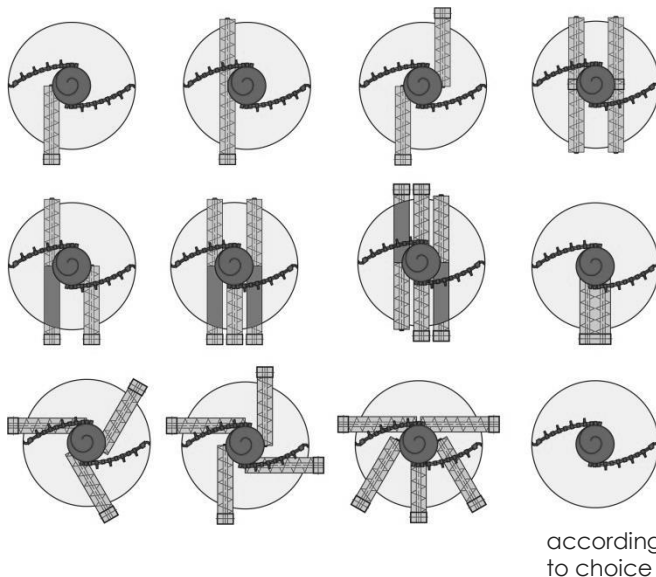

Alternative digging tools

The manufacture of the drag arms depends on the bulk material.

